

Square / Round Bars



Square / Round Bars



Round Bars

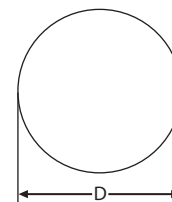

(Metric units)

Section Size	Unit Weight	Cross Section Area
Dia	Mass	Area
mm	kg/m	cm ²
6	0.22	0.28
10	0.62	0.79
12	0.89	1.13
13	1.04	1.33
14	1.21	1.54
16	1.58	2.01
18	2.00	2.55
19	2.23	2.04
20	2.47	3.14
22	2.98	3.80
24	3.55	4.52
25	3.85	4.91
26	4.17	5.31
28	4.83	6.16
29	5.19	6.61
30	5.55	7.07
32	6.31	8.04
35	7.55	9.62
38	8.90	11.34
44	11.90	15.21
50	15.40	19.63
65	26.00	33.18
75	34.70	44.18
90	49.90	63.62
100	61.70	78.54
125	96.30	122.70
150	139.00	176.70
200	247.00	314.20

Material Spec:
 EN10025 S275JR
 BS4360 Gr43A
 JIS G3101 SS400
 S20C
 S45C

Square Bars

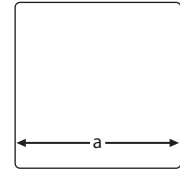

(Metric units)

Section Size	Unit Weight M		Side Length a		Section Area A		Moment of Inertia	Radius of Gyration	Modulus of Section
	mm	kg/m	lb/ft	mm	in	cm ²			
9	0.64	0.43	9	0.35	0.81	0.13	---	---	---
10	0.79	0.53	10	0.39	1.00	0.15	---	---	---
12	1.13	0.76	12	0.47	1.44	0.22	---	---	---
16	2.01	1.35	16	0.63	2.56	0.40	0.01	0.18	0.04
17	2.27	1.53	17	0.67	2.89	0.45	0.02	0.19	0.50
18	2.54	1.71	18	0.71	3.24	0.50	0.02	0.21	0.06
19	2.83	1.90	19	0.75	3.61	0.56	0.03	0.22	0.07
20	3.14	2.11	20	0.79	4.00	0.62	---	---	---
22	3.80	2.55	22	0.87	4.84	0.75	0.05	0.25	0.11
23	4.15	2.79	23	0.91	5.29	0.82	0.06	0.26	0.12
24	4.52	3.04	24	0.94	5.76	0.89	0.66	0.27	0.14
25	4.91	3.30	25	0.98	6.25	0.97	0.08	0.28	0.16
26	5.31	3.57	26	1.02	6.76	1.05	0.09	0.30	0.18
28	6.15	4.13	28	1.10	7.84	1.22	0.12	0.32	0.22
30	7.07	4.75	30	1.18	9.00	1.39	0.16	0.34	0.28
32	8.04	5.40	32	1.26	10.24	1.59	0.21	0.36	0.33
34	9.07	6.09	34	1.34	11.56	1.79	0.27	0.39	0.40
35	9.62	6.46	35	1.38	12.25	1.90	0.30	0.40	0.44
36	10.2	6.85	36	1.42	12.96	2.01	0.34	0.41	0.48
38	11.3	7.59	38	1.50	14.44	2.24	0.42	0.43	0.56
44	15.2	10.21	44	1.73	19.36	3.00	---	---	---
50	19.6	13.17	50	1.97	25.00	3.87	1.25	0.57	1.27
55	23.7	15.93	55	2.17	30.25	4.69	1.83	0.63	1.69
60	28.3	19.02	60	2.36	36.00	5.58	2.60	0.68	2.20
65	33.2	22.31	65	2.56	42.25	6.55	3.58	0.74	2.80
70	38.5	25.87	70	2.76	49.00	7.59	4.81	0.80	3.49
75	44.2	29.70	75	2.95	56.25	8.72	6.34	0.85	4.29
80	50.2	33.73	80	3.15	64.00	9.92	8.19	0.91	5.21
85	56.7	38.10	85	3.35	72.25	11.20	10.45	0.97	6.22
90	63.6	42.74	90	3.54	81.00	12.55	13.14	1.02	7.38
95	70.8	47.58	95	3.74	90.25	13.99	16.31	1.08	8.73
100	78.5	52.75	100	3.94	100	15.50	20.01	1.14	10.19
110	95	63.84	110	4.33	121	18.75	29.31	1.25	13.55
120	113	75.93	120	4.72	144	22.32	41.56	1.36	17.58
130	133	89.37	130	5.12	169	26.19	57.18	1.48	22.33
140	154	103.48	140	5.51	196	30.38	76.88	1.59	27.89
150	177	118.94	150	5.91	225	34.87	101.38	1.71	34.30
160	201	135.07	160	6.30	256	39.68	131.20	1.82	41.68

Material Spec: EN10025 S275JR
 BS4360 Gr43A
 JIS G3101 SS400